



bar

MPM426WPF Level Transmitter

MICROSENSOR

AUTHORIZED DISTRIBUTOR



The MPM426WPF level transmitter is a fully welded, submersible level measurement device. It uses a piezoresistive OEM pressure sensor with proven long-term stability and reliability, and a special digital compensation circuit that are built into a stainless steel housing. The integrated structure and standardized output signal make it easy for the on-site use and automatic control. The vented cable and the housing are hermetically sealed, can be used in the liquids that are compatible with the sensor material for a long time. It is mainly applied for the pressure measurement and control of petrochemicals.

FEATURES

- High Reliability, Safe and Easy to Use
- Short Circuit and Reverse Polarity Protection
- Automatic Production Line Ensures High Quality and Stability
- Stainless Steel 316L Housing and IP68

SPECIFICATION

Level range: 0mH₂O~2mH₂O/3.5mH₂O/5mH₂O
/ 10mH₂O / 20mH₂O/35mH₂O

Pressure Type: Gauge

Overload: 1.5 ×FS

Power Supply: 9V~28V DC or 5V DC

Output Signal: 0.5V~4.5V DC (3-wire)

Accuracy ^① : ±1% FS (≤ 3.5m H₂O)
±0.5% FS (>3.5m H₂O)

Total Error ^② : ±2% FS (≤ 3.5m H₂O , -20℃ ~75℃)
±1.5% FS (> 3.5mH₂O , -20℃ ~75℃)

Long-term Stability: ≤ ±0.3%FS/year

Working Temperature: -20℃ ~80℃

Storage Temperature: -20℃ ~85℃

Insulation Resistance: 100V@100MΩ

Load Resistance: ≥ 10kΩ

Protection Rating: IP68

Weight: about 260g (Including no cable), cable is
about 70g/m

①: Test at normal temperature (reference condition
20℃ ±5℃), non-linear;

②: The accuracy includes non-linearity, repeatability
and hysteresis within the working temperature range.





CONSTRUCTION MATERIAL

Housing: stainless steel 316L

Diaphragm: stainless steel 316L

Cable: \varnothing 7.5mm Polyurethane Cable

OUTLINE DIMENSION (Unit: mm)

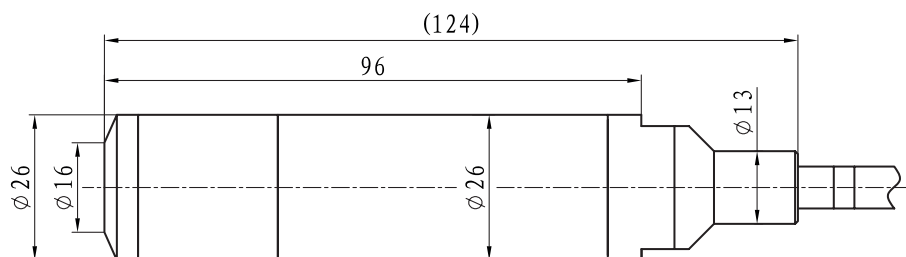

ELECTRICAL CONNECTION

Electrical Connection	Wire color
+V	BLACK
+OUT	RED
GND	WHITE
Casing	GREEN

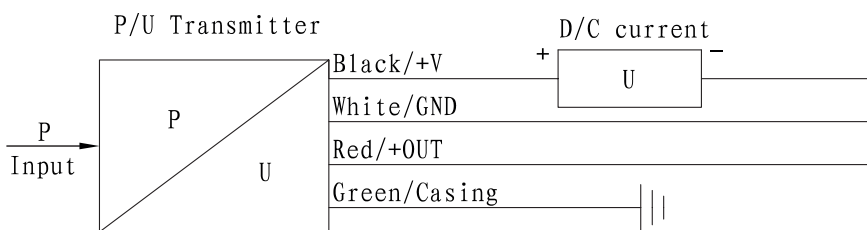

MPM426WPF Wiring Diagram



ORDER GUIDE

MPM426WPF		Level Transmitter					
Range		0mH ₂ O ~ 2mH ₂ O/3.5mH ₂ O/5mH ₂ O/10mH ₂ O/20mH ₂ O/35mH ₂ O					
[0 ~ XmH ₂ O]L		X: the actual measured pressure L: cable length suggested L-X= (1~2) m					
Code		Power supply					
V1		9V ~ 28V DC					
V6		5V DC (Suggested cable length ≤10m)					
Code		Output signal					
K		0.5V ~ 4.5V DC					
Code		Material					
		Diaphragm		Pressure Port		Housing	
24		SS316L		SS316L		SS316L	
Code		End Cap					
D1		Ø26mm stainless steel cap with 4×φ2mm holes at the cap bottom					
D2		Ø26mm black nylon cap with 4×φ2mm holes at the cap side					
Code		Others					
G		Gauge					
MPM426WPF	[0 ~10mH ₂ O]5	V1	K	24	D1	G	the whole spec

NOTES

1. The measured media should be compatible with the sensor material, and please provide the density of the media in the measurement (except water);
2. For sensors with 5VDC as the power supply, the cable length suggested should be ≤10m;
3. Default end cap is D1 unless specified;
4. If the user has special requirements, please feel free to contact us.